

BALDWIN ROAD UPDATE

A regular update on the Baldwin Road widening project in Orion Township provided by the Road Commission for Oakland County.

WITH WALDON AND MAYBEE BOTH CLOSED AT WEST SIDE OF BALDWIN, MOST WORK WILL BE OUT OF TRAVELED ROAD FOR COMING MONTHS

Now that the contractor for the Baldwin Road project has closed both Waldon and Maybee roads at the west side of Baldwin Road, most of the project work for the next several months will take place in the closed sections of Waldon and Maybee and on the southbound lanes of Baldwin — out of the currently traveled roadway.

As a result, the Road Commission for Oakland County (RCOC) will provide future Baldwin Road project updates when there is a noteworthy development that will impact traffic or the local community.

In the meantime, please direct any questions to the Road Commission via phone, e-mail or Website:

- Phone: 877-858-4804 (7:30 a.m. to 4:15 p.m., Monday through Friday)
- E-mail: dcsmail@rcoc.org
- Website: Click on the “Report an Issue” button at the top center of the RCOC website homepage and fill out the form (the website is www.rcocweb.org)

Due to the threat of COVID-19, please be “corona-courteous” and do not approach Road Commission or contractor workers on the project.

Detour route

The detour route for both Waldon and Maybee roads while both are closed at the west side of Baldwin Road is Baldwin Road to Gregory Road to Rohr Road to Maybee Road to Clintonville Road to Waldon Road and vice versa (see map below). Both are expected to be closed until July.

Waldon and Maybee detour route

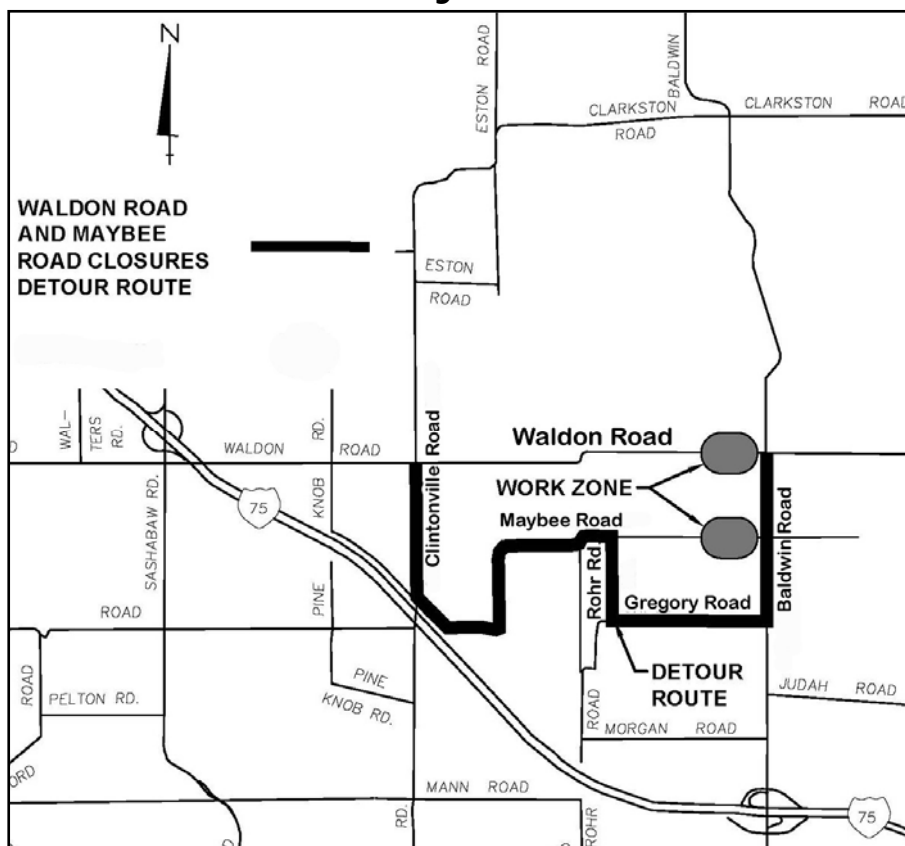

For more information:

Call RCOC's Department of Customer Services at (877) 858-4804 or send us an email at dcsmail@rcoc.org or via the RCOC website, www.rcocweb.org.