

Traffic Safety Construction Detour Diagram

- CC
- AS DIRECTED BY THE ENGINEER, SIGNS, BARRICADES AND LIGHTS
 - THE CONTRACTOR SHALL PLACE MOVEMENT OF THE BARRICADES AND LIGHTS IN THE NUMBER REQUIRED (THIS SHEET)
 - THE CONTRACTOR SHALL BE RE-AS NEEDED FOR THE PROPER
 - TRAFFIC CONTROL SIGNS AND S MAINTAINED BY THE CONTRACTOR. A COMMISSION MAY FURNISH AND CONTRACTOR SHALL RELOCATE THE PROJECT ENGINEER.
 - ANY OTHER SIGNS, WHICH THE MICHIGAN MANUAL OF UNIFORM OPERATIONS ON THE PROJECT, L RELOCATED AND STRENGTHENED.
 - ALL TYPE III BARRICADES FURNISHED WITH REFLECTORS ATTACHED AND MAINTAINED.
 - THE CONTRACTOR SHALL PROVIDE THE PLANS OR AS DIRECTED BY
 - ALL CONSTRUCTION TRAFFIC SA PROJECT WILL BE RELOCATED B MAINTAINED BY THE CONTRACTOR. CAN NOT BE RELOCATED BY THE BE CHARGED FOR THESE TRAFFIC COMMISSION, THAT WERE DAMA.
 - TEMPORARY PAVEMENT MARKIN TEMPORARY MARKINGS WILL BE REMOVE ANY EXISTING CONFLIC MARKINGS.
 - ALL CONSTRUCTION WARNING S.

- ROAD CC
- THE ROAD COMMISSIONER HAS LOCATIONS SHOWN ON THE CON
 - THE ROAD COMMISSIONER HAS MAINTENANCE INTERSECTIONS P
 - WHERE A DETOUR IS NECESSARY DETOUR ROUTE.
 - ALL CONSTRUCTION SIGNS SHALL OTHERWISE SPECIFIED.

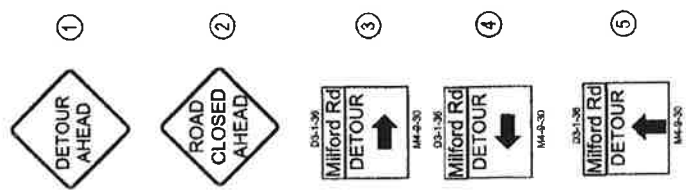
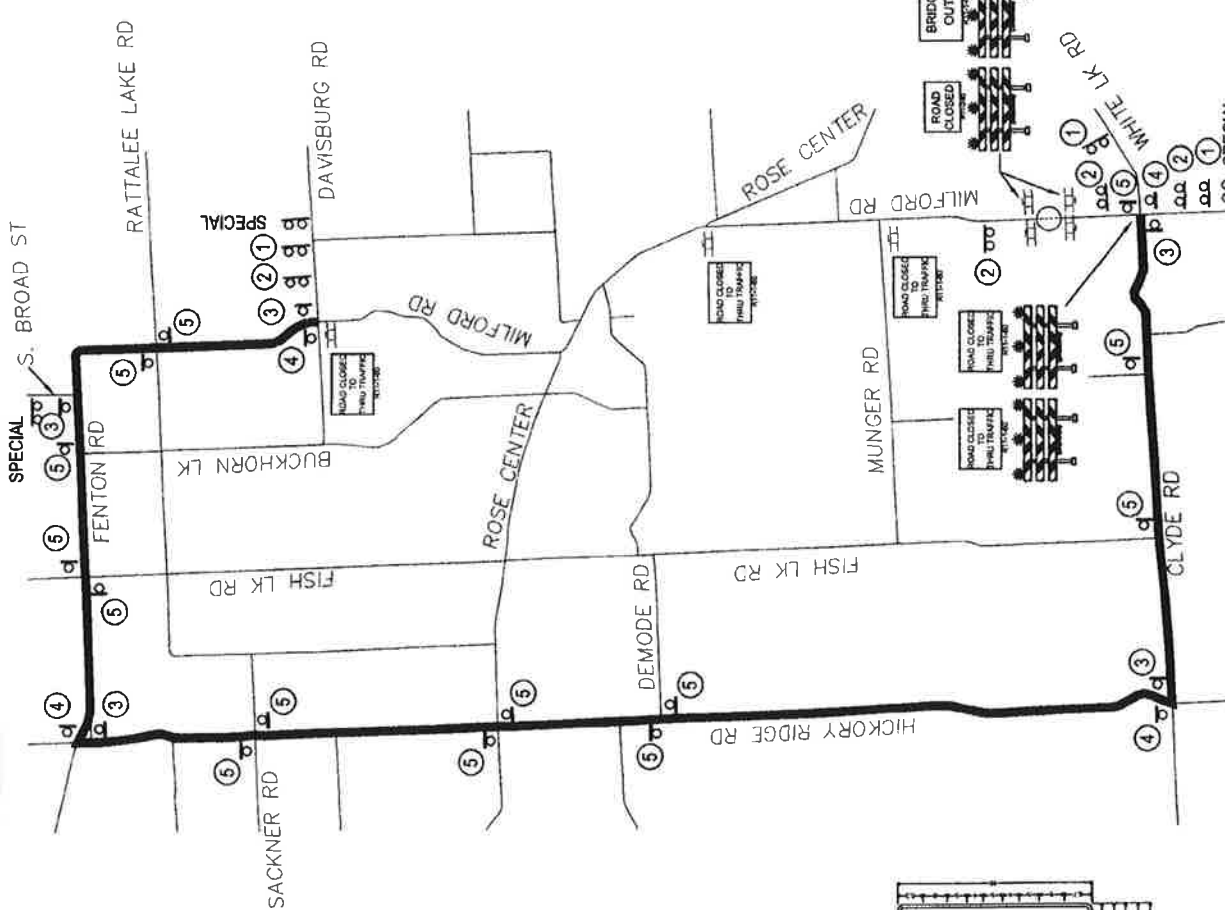
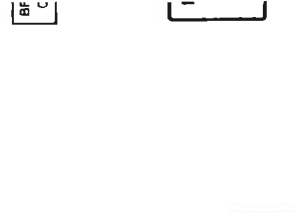
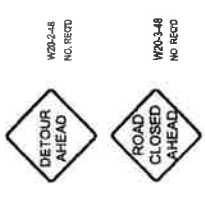

Milford Rd Closed
 North of
 White Lake Rd
Follow Detour



ROAD COMMISSION	DATE	PROJECT NO.
FOR OAKLAND COUNTY	3/15/18	XXXXX
Barry, Mich., Michigan		

Scale: 1" = 1/4" Tech. Apr.

SPECIAL