

BALDWIN ROAD UPDATE

A monthly update on the Baldwin Road widening project in Orion Township provided by the Road Commission for Oakland County.

WALDON AND MAYBEE TO BE CLOSED AT WEST SIDE OF BALDWIN SO SEWERS, PAVEMENT, SIGNALS AND SIDEWALKS CAN BE FINISHED

The prime contractor for the Road Commission for Oakland County (RCOC), Dan's Excavating, expects to close Waldon Road at the west side of Baldwin Road on Monday, **March 30**, and Maybee Road at the west side of Baldwin Road on approximately Monday, **April 6**.

Both roads are then expected to remain closed on the west side of Baldwin Road until approximately July, though the completion date could be sooner or later depending on the weather. The closures are needed so Dan's Excavating can finish sewer line installations and complete the pavement and signal work on the west side of each intersection, including both the roadway and sidewalks/crosswalks.

Once the work is completed on the west side of the intersections, and both west legs have re-opened to traffic, both roads (Waldon and Maybee) will then be closed on the east side of Baldwin to complete work on that side.

Detour routes

The detour route for Waldon traffic between March 30 and April 6 is Baldwin to Maybee to Clintonville and back to Waldon and vice versa.

The detour route for both Waldon and Maybee after Maybee closes on approximately April 6 is Baldwin to Gregory to Rohr to Maybee to Clintonville to Waldon and vice versa.

Waldon detour, March 30 to April 6.

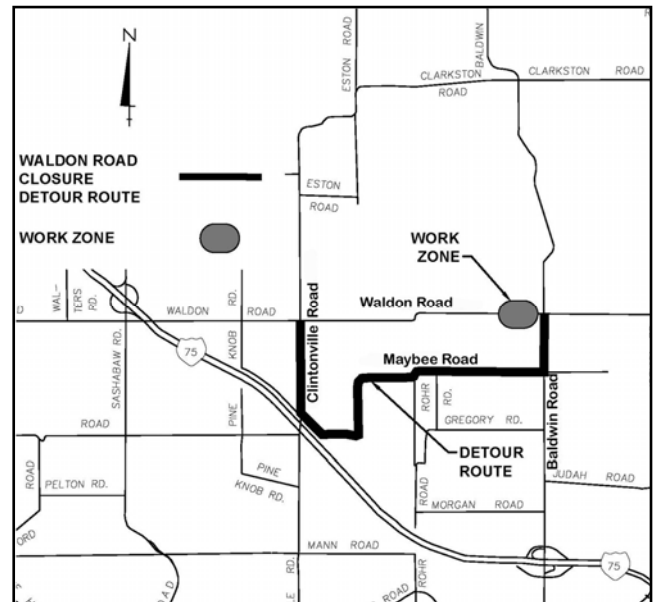

Waldon and Maybee detour after April 6.

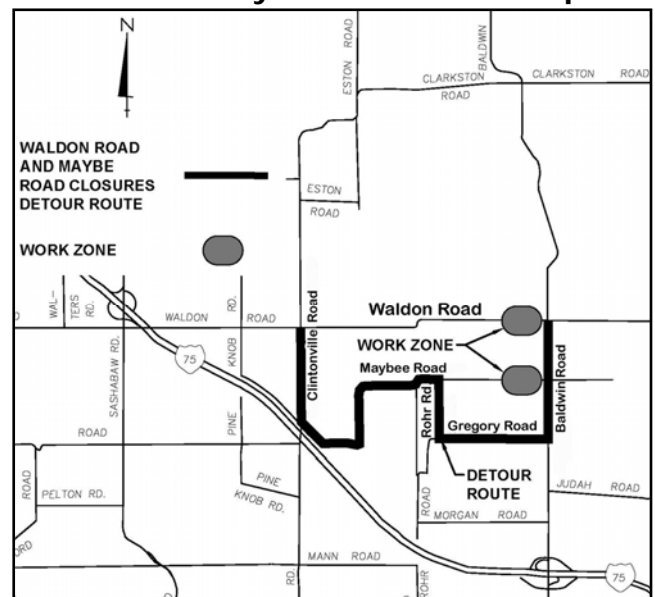

For more information:

Call RCOC's Department of Customer Services at (877) 858-4804 or send us an email at dcsmail@rcoc.org or via the RCOC website, www.rcocweb.org.